

Monteringsveiledning for sertifiserte brannvindu.
Installation instruction for certified fire windows.

Det skal ikke foretaes fresing, skjering eller annen bearbeiding av vinduet.
Any machining/milling/planing is forbidden.

Lukke ved siden av lukke.
Coupling, inward opening. Horizontal cross section.

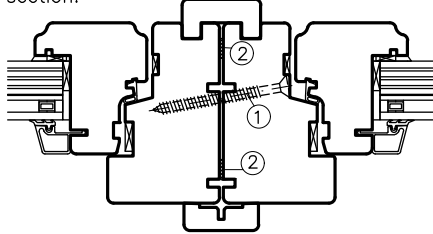

Fast ved siden av fast
Horizontal cross section: Fixed light.

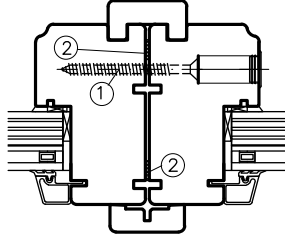

Lukke ved siden av fast.
Horizontal cross section: inward opening beside Fixed light.

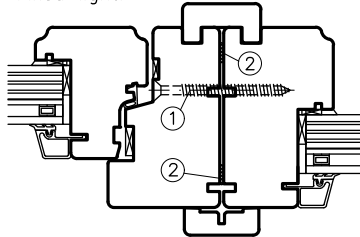

Fast over fast.
Coupling Fixed light. Vertical cross section.

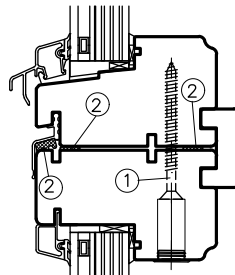

Lukke over lukke.
Coupling, inward opening. Vertical cross section.

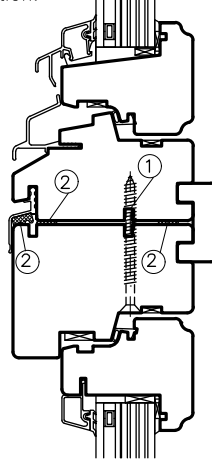

Fast over lukke.
Coupling. Fixed over inward opening Vertical cross section.

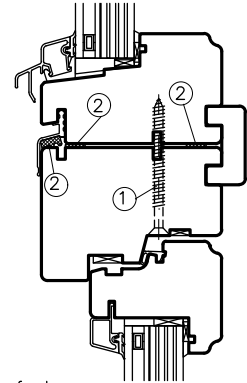

Lukke over fast.
Coupling, inward opening over fixed. Vertical cross section.

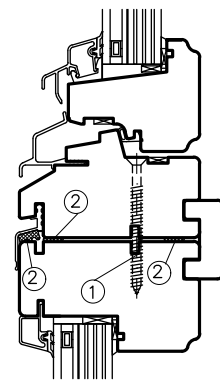

1. Treskruer (Screw) 6.0 x 70 mm.
2. Nordsjøl. E-profil (Gasket) 4x8mm.

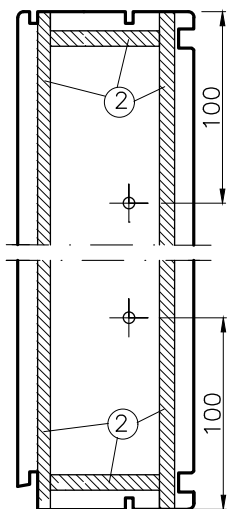

Vert/horizontal snitt.
Skrueavstand fordeles likt.

Vertical/Horizontal cross-section.
The space between the screw shall be equally.

- Høyde/bredde opp til (Height/length up to) 588: 2 stk.
- Høyde/bredde (Height/length) over 588 til 988: 3 stk.
- Høyde/bredde (Height/length) over 988 til 1488: 4 stk.
- Høyde/bredde (Height/length) over 1488: 5 stk.

Byggets ansvarshavende skal sikre at monteringsveiledningen blir fulgt og er ansvarlig for at denne blir oppbevart som et byggesaks-dokument for fremvisning ved behov.

Responsible personnel shall ensure the mounting instructions are followed and are also responsible for secure storage of this document.

Det skal følge med en monteringsveiledning pr. vindu.
Installation instruction shall follow each window.

Ordre nr. (Order number): _____

Monteringsdato/år (Date of installation): _____

Signatur (Signature) : _____

NorDan AS
Stasjonsveien 46
N-4460 Moi
Telefon: +47 51404000.
e-post: firmapost@nordan.no
hjemmeside: <http://www.nordan.no>

Brannvindu

EI30 vinduer (Windows)

ND Sammensetning. Horisontal- og vertikalsnitt.

ND coupling. Horizontal and vertical section.

Gen. Tol.:

Konstr: 20.08.04

Sign: Hg

Godkj: 16.01.20

Sign: RR

Rev: 16.12.19

Sign: RR

Mål: 1:



Henv: 142-05

RNDBV

Tegn.nr:

AMW Rev: A

Rev:

R040055

G